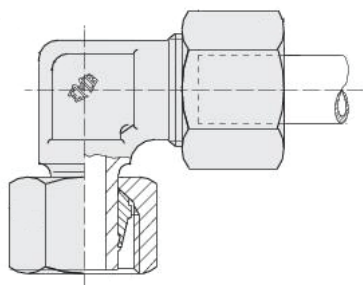
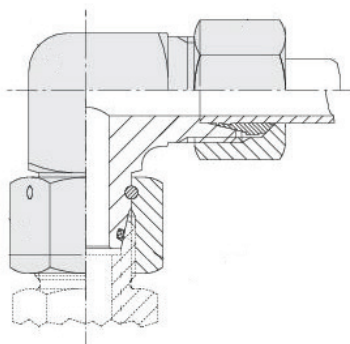

ASSEMBLY INSTRUCTION STUD END AND TAPER CONNECTION (DKO)**Fully mounted cutting ring connectors with shaft type VA, VB, VC, VD, RL, RS**

Oil the thread. Then insert the shaft into the screw connection and tighten with a wrench until there is a noticeable increase in force. For the final assembly of the shaft side, the union nut is tightened 30°-60° past the point of a noticeable increase in force.

Taper couplings type VADKO, VBDKO, VCDKO, VDDKO, RLDKO, RSDKO

Oil the thread of the screw connection and O-shaped ring of the taper connection [DKO] side. Insert the taper couplings into a straight screw-in connection and tighten by hand. For the final assembly of the taper connection side, the union nut is tightened with 1/4 to 1/2 turns. The screw connection must be held using a suitable wrench.

Tube quality

We recommend the use of seamless precision steel tubing with dimensions in accordance with DIN EN ISO 10305 Part 4, Material: E235, NBK.

Tubes from rust and acid-proof material must be seamlessly cold-drawn, scale-free and heat-treated in accordance with DIN EN 10216-5 - X6 CrNiMoTi17-12-2-CFD and exhibit tolerances in accordance with DIN EN ISO 10305-1.